

5/23/18

HANNEY & ASSOCIATES ARCHITECTS
 1726 South Hillside, Wichita, Kansas 67211
 Phone (316) 683-6955
 Fax (316) 684-1441

2018 GENESIS HEALTH CLUBS OVERLAND PARK
 6700 W 110 Street, 66211

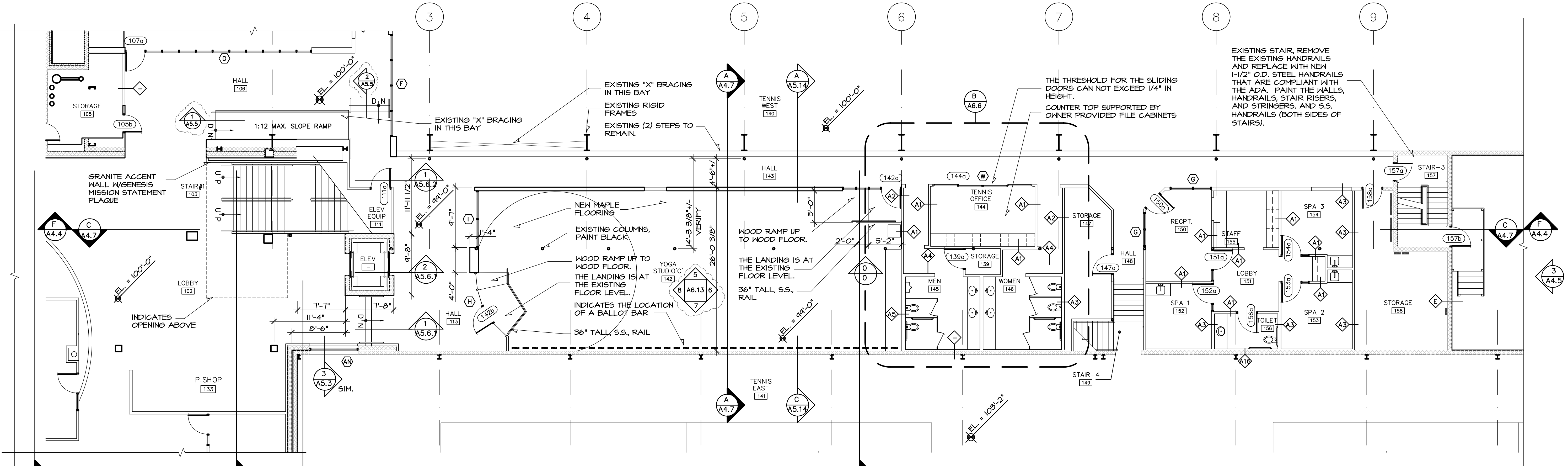

A PARTIAL MAIN FLOOR PLAN
 SCALE: 1/8" = 1'-0"

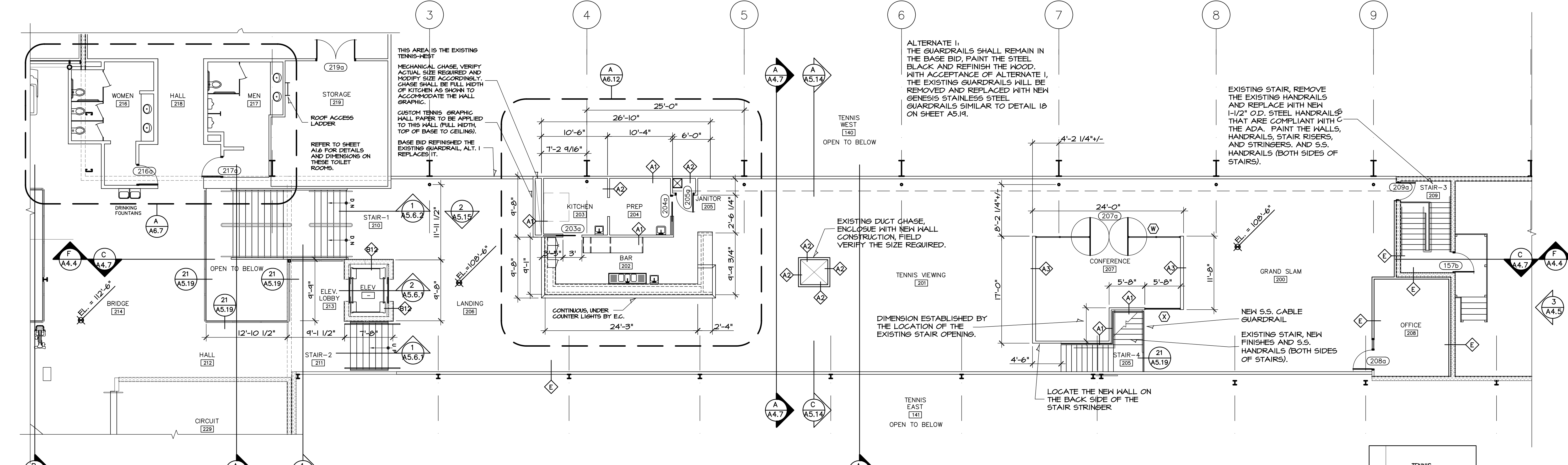
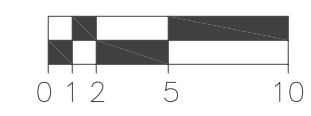

B PARTIAL MEZZANINE PLAN
 SCALE: 1/8" = 1'-0"

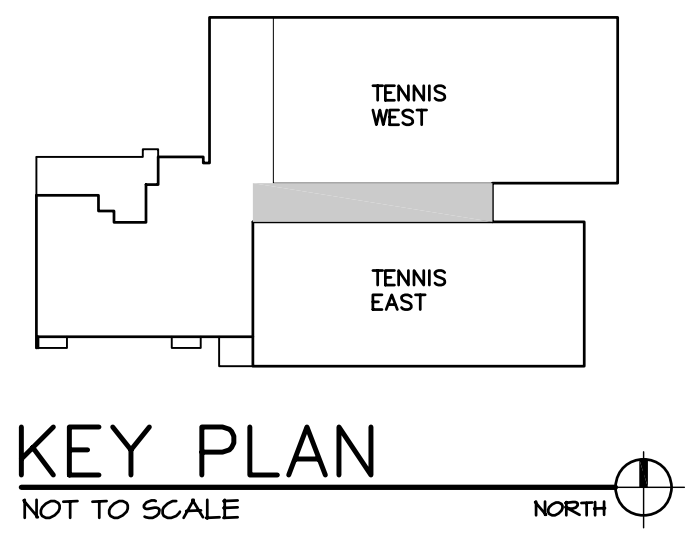
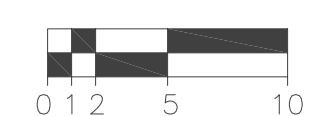

DRAWINGS ISSUED			
NO.	DATE	ITEM	ISSUED
14	5/23/18	PLAN REVIEW	
15	4/21/18	PLAN REVIEW	
17	2/12/18	PERMIT	
16	2/09/18	CHECK SET	
15	2/02/18	CHECK SET	
14	01/15/18	CHECK SET	
13	01/08/18	CHECK SET	

COMPUTER DRAWING
 OP_A105.DWG

DATE: FEBRUARY 2018
 DRAWN BY: CHECKED BY:
 MH, CH, BS, TH MRH

SHEET
A1.5
 OF SHEETS