

HANNEY & ASSOCIATES, ARCHITECTS
 1726 South Hillside, Wichita, Kansas, 67211
 Phone (316) 883-8965
 Fax (316) 884-1441
 www.haarchitects.com

DEMOLITION NOTES:

1. DEMOLITION PLANS SHOW THE GENERAL EXTENT OF THE ELECTRICAL DEMOLITION WORK. THE ELECTRICAL CONTRACTOR SHALL DISCONNECT ELECTRICAL SERVICES TO ALL EQUIPMENT BEING REMOVED, SEE MECHANICAL PLANS. OWNER SHALL HAVE THE OPTION TO RETAIN REUSABLE ITEMS, SUCH AS COVERPLATES, RECEPTACLES, LIGHTS, PANELS, ETC. NOT BEING USED IN THE FINISHED WORK. COORDINATE WITH OWNER PRIOR TO STARTING DEMOLITION. PROPERLY AND LEGALLY DISPOSE OF ALL EQUIPMENT AND MATERIALS BEING REMOVED.
2. REMOVE ALL CONDUIT LEFT EXPOSED BY REMOVAL OF WALLS AND CEILINGS IN REMODELED AREAS. PLUG BOTH ENDS OF REMAINING CONDUIT IN WALL OR FLOOR WHERE CUT.
3. ELECTRICAL OUTLETS, ETC. POSSIBLY CONCEALED BY STORAGE SHELVING, CASEWORK, FURNITURE, ETC. ARE NOT SHOWN AND MAY REQUIRE REMOVAL.
4. GENERAL CONTRACTOR SHALL BE RESPONSIBLE FOR PATCHING ALL OPENINGS IN EXISTING CONSTRUCTION AFTER REMOVAL OF EQUIPMENT AND ELECTRICAL DEVICES, ETC.
5. WHERE EQUIPMENT AND OTHER DEVICES ARE BEING REMOVED, THE CIRCUITING SHALL BE REMOVED, IF POSSIBLE, BACK TO POINT OF SUPPLY. WHERE REQUIRED, CIRCUITING SHALL BE EXTENDED TO MAINTAIN CONTINUITY OF THE CIRCUIT OR OPERATION OF THE SYSTEM.
6. ALL DEVICES SHOWN DASHED ON THE DEMOLITION PLAN(S) SHALL BE REMOVED, UNLESS NOTED OTHERWISE.
7. PROVIDE MATCHING BLANK COVERPLATES WHERE DEVICES ARE BEING REMOVED FROM EXISTING WALLS TO REMAIN.
8. FIELD VERIFY ALL EXISTING CONDITIONS AND DIMENSIONS PRIOR TO BEGINNING WORK.

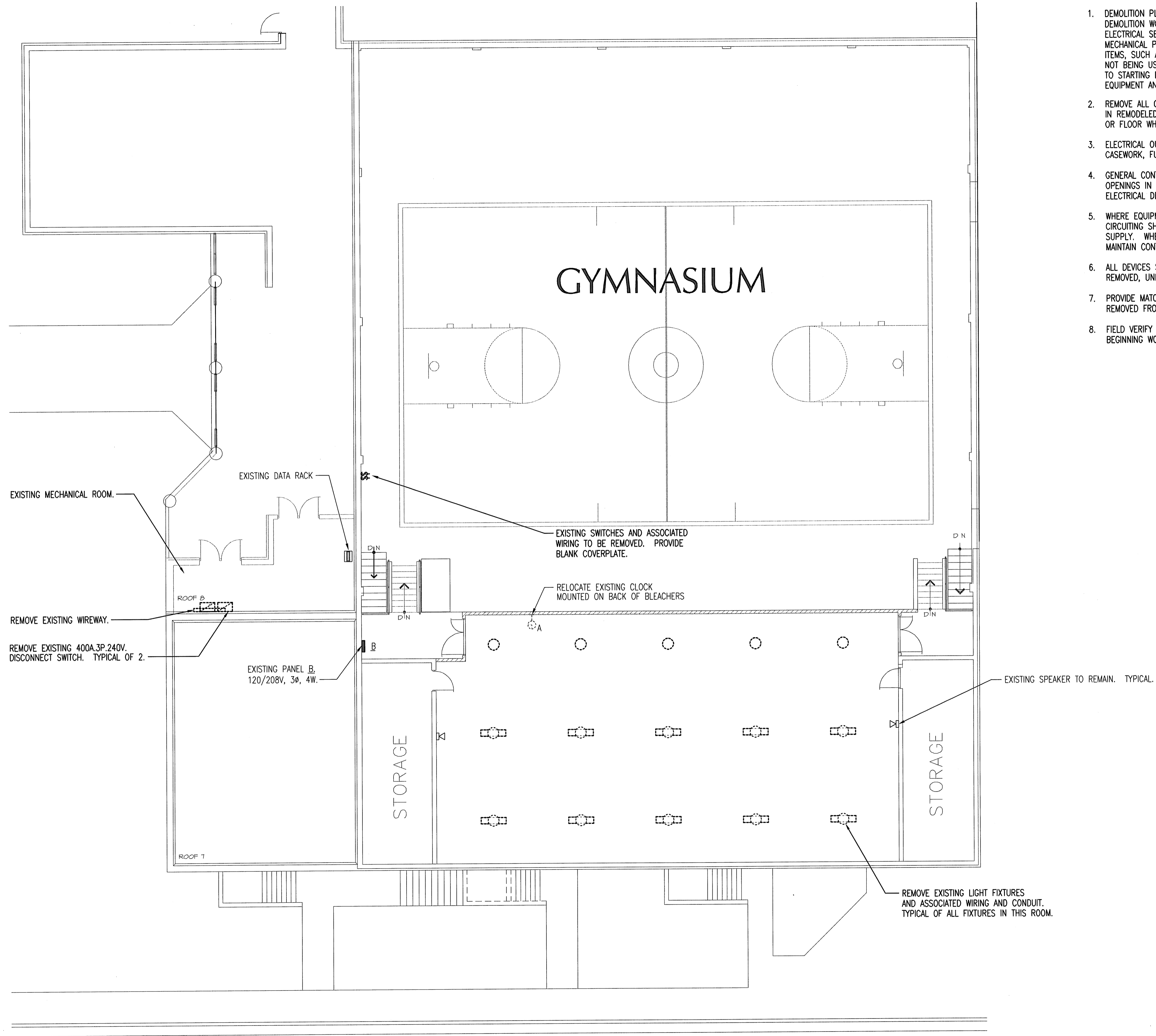

EXISTING MECHANICAL ROOM.

EXISTING DATA RACK

EXISTING SWITCHES AND ASSOCIATED WIRING TO BE REMOVED. PROVIDE BLANK COVERPLATE.

RELOCATE EXISTING CLOCK MOUNTED ON BACK OF BLEACHERS

REMOVE EXISTING WIREWAY.

REMOVE EXISTING 400A.3P.240V. DISCONNECT SWITCH. TYPICAL OF 2.

EXISTING PANEL B. 120/208V, 3Ø, 4W.

EXISTING SPEAKER TO REMAIN. TYPICAL.

REMOVE EXISTING LIGHT FIXTURES AND ASSOCIATED WIRING AND CONDUIT. TYPICAL OF ALL FIXTURES IN THIS ROOM.

ELECTRICAL DEMOLITION PLAN - ALTERNATE #4
 1/8" = 1'-0"

Saved 04-20-2009 8:05:42 AM by JLL
 Plot Scale 1:56 04-20-2009 8:42:16 AM
 E:\2008\08004\002\08004-002-ED2-ELECTRICAL DEMO PLAN

2009
 GARDEN PLAIN HIGH SCHOOL - NEW GYM
 GARDEN PLAIN, KANSAS
 RENWICK UNIFIED SCHOOL DISTRICT 267

DRAWINGS ISSUED	
NO.	DATE
1	4/17 FOR BIDS

COMPUTER DRAWING

DATE: APRIL 2009
 DRAWN BY: JLM CHECKED BY: DLD

SHEET

ED1.2

OF 16 SHEETS

Professional Engineering Consultants, P.A.
 303 S. TOPEKA • WICHITA, KANSAS 67202 • 316-262-2691 • FAX 316-262-3003
 www.pact.com