

HANNEY & ASSOCIATES, ARCHITECTS
 1728 South Hillside, Wichita, Kansas, 67211
 Phone (316) 683-9965
 Fax (316) 684-1441

HADLEY MIDDLE SCHOOL
 WICHITA PUBLIC SCHOOLS
 PHASE 1B- PROJECT #09-25012
 WICHITA, KANSAS
 UNIFIED SCHOOL DISTRICT #259



DRAWINGS ISSUED		
NO.	DATE	ITEM ISSUED
6	4/23/10	ADDENDUM 2
5	4/01/10	ISSUED FOR BID
4	3/08/10	100% REVIEW
3	2/12/10	50% REVIEW
2	12/21/09	DESIGN DEVELOPMENT
1	10/2/09	SCHEMATIC REVIEW

COMPUTER DRAWING
 25494HDS2.DWG

DATE: APRIL 16, 2010
 DRAWN BY: JP
 CHECKED BY: MRH

SHEET

SP2

OF - SHEETS

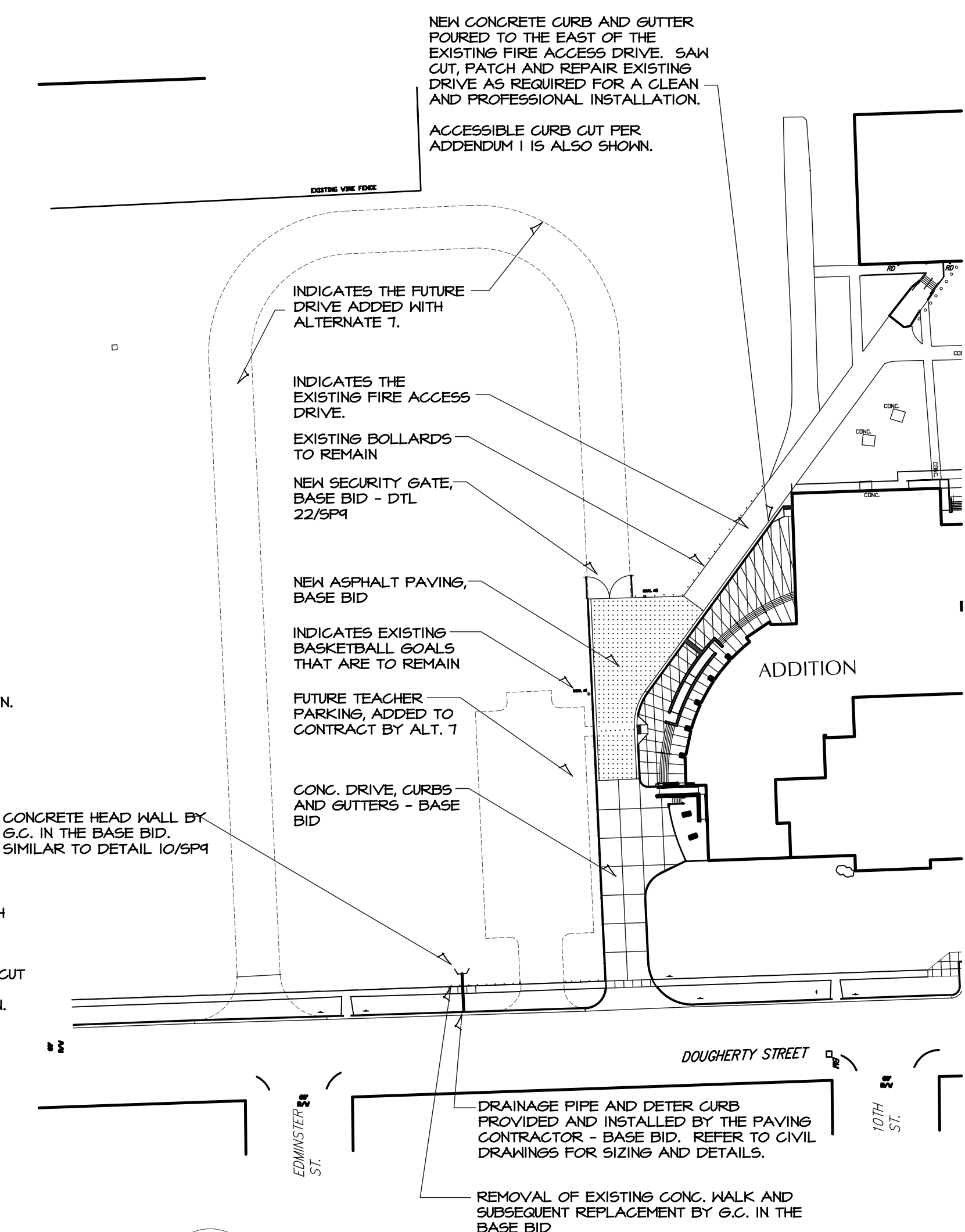

B PARTIAL BASE BID - PAVING
 SCALE: N.T.S.

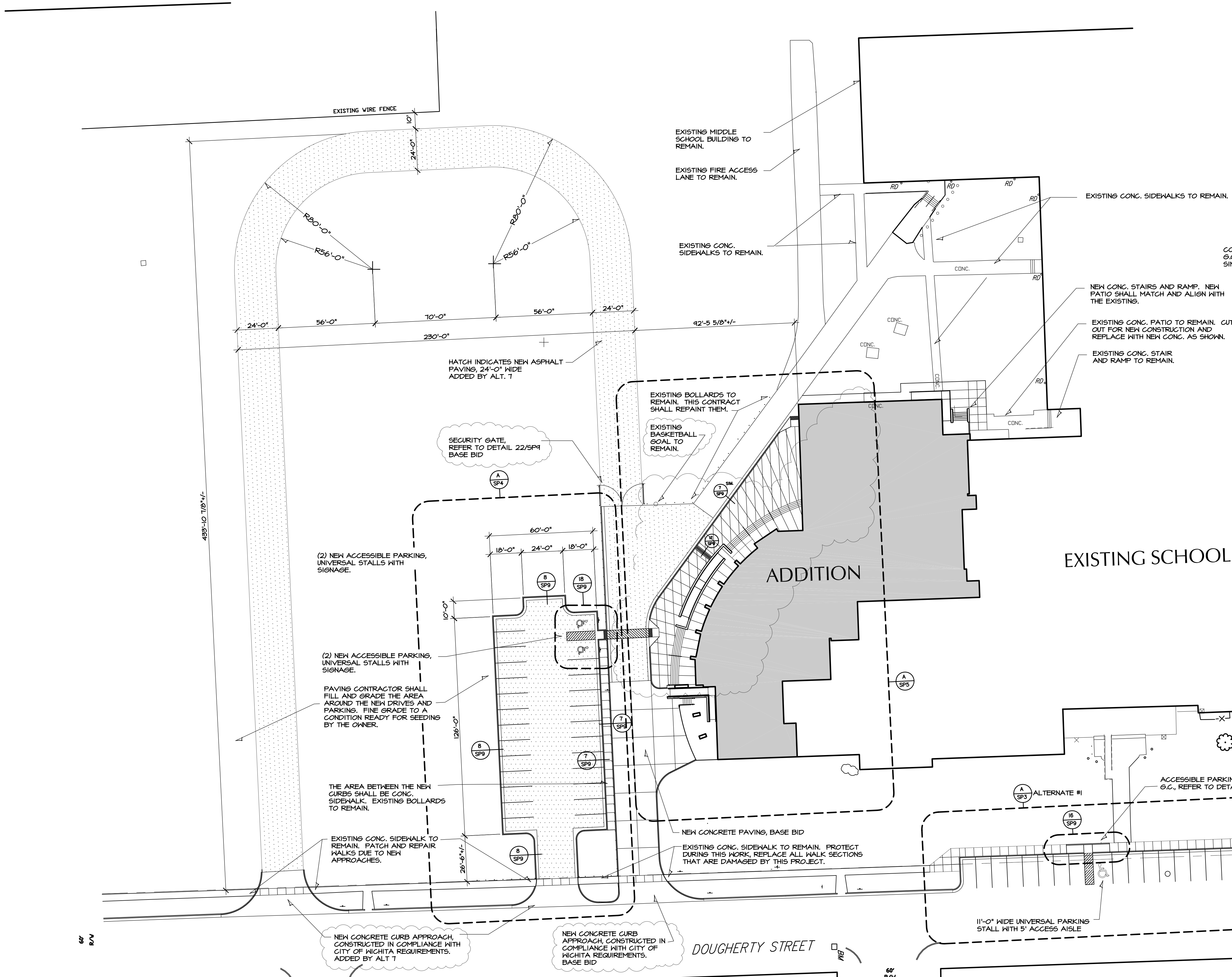

A PARTIAL SITE PLAN - NEW PAVING
 SCALE: 1" = 30'-0"