

Addendum Number One

To The Drawings and Specifications for
Hadley Middle School – Wichita, Kansas
Wichita Unified School District # 259

Issued: April 16, 2010

HANNEY & ASSOCIATES ARCHITECTS

1726 South Hillside, Wichita, Kansas

NOTICE TO BIDDERS

You are hereby instructed to include in your bids the following changes and/or corrections to the Drawings and Specifications for the Hadley Middle School Addition/Renovations in Wichita, Kansas.

The additions and/or corrections shall be considered as a part of the Contract Documents as if incorporated therein. Where the following corrections and/or additions vary from the conditions of the Drawings and Specifications, such following changes or additions shall govern.

I. GENERAL CLARIFICATIONS:

1.1 The following companies had a representative attend the pre-bid meeting held on Thursday, April 8, 2010. This meeting was mandatory for all General Contractors wishing to bid.

Simpson & Associates	Key Construction	Compton Construction
Caro Construction	Kilian Electrical Service	Eby Construction
Straub Construction	Crossland Construction	Breckco Construction Co.
Coonrod & Associates	Graf Electric	Harmon Construction
Walz Harman Huffman	Pro. Mechanical Contractors	Commerce Construction
The Law Co., Inc.	Don Vaughn Inc.	Sauerwein Construction
Robl Commercial Construction	Commercial Mechanical	Builders, Inc.

1.2 The Wichita USD 259 - Bid Number has changed. The new Bid Number is **10-25012**. A new bid form is issued as part of this addendum. The form is posted on our web page so it can be downloaded by the General Contractors.

1.3 All asbestos abatement shall be by USD 259's contractor. Any reference to abatement by the general contractor shall be corrected. The general contractor shall coordinate with the school district's contractor but shall not included abatement in their proposal.

1.4 Construction Completion (Instructions to Bidders – Section 00100)
Paragraph 1.15 Construction Time and Liquidated Damages, item A. Listing of project milestones shall be corrected to extend the completion time with the project being executed in three phases:

- Phase 1 completion – new construction – 9 months to complete.
- Phase 2 completion – lunch room conversion into offices - 2 to 3 months to complete.
- Phase 3 completion - conversion of admin to classrooms 2-months to complete.
- Project Substantial Completion – Thursday, June 30, 2011.

II. CHANGES TO THE SPECIFICATIONS:

- 2.1 Section 00100 – Instructions to Bidders
- 2.1.1 Add item 1.21, A. Project Sign:
Provide and erect a project sign of a size approximately 8'-0" wide x 4'-0" high, 3/4" thick, plastic faced marine plywood. The sign shall include the graphic provided by the Owner, Owner (USD 259), name of the School, bond manager, architect, general contractor, mechanical contractor, and electrical contractor - all in accordance with the USD 259 standards.
- 2.2 Section 00310-1 Bid Form
- 2.2.1 Shall be revised to add Alternate 7 – Teacher Parking Lot
This alternate considers the cost of the Teachers Parking Lot as detailed on sheet SP4, Plan "A". Refer to comments in this addendum for a clarification as to the scope of work (Sheet SP4).
- 2.2.2 The bid form has been revised to include the correct USD 259 bid number and additional alternate.
- 2.2.3 The revised bid form is posted on our web site: www.haarchitects.com, click the shortcut to plan room at the bottom of the page. The bid form will be in PDF format that can be downloaded by the General Contractors separate from this addendum.
- 2.3 Section 01500 – Temporary Facilities and Controls
Electrical Power during construction
It shall be clarified that the USD 259 Standards will require the General Contractor to include and pay for temporary electrical service for the Phase 1 portion of the construction. This is defined as the new construction outside the footprint of the existing building. Once the work moves to remodel of existing interior spaces (Phases 2 and 3) the temporary electrical service can be terminated and electrical for this construction can come from existing sources.
- 2.4 Section 04200 – Masonry
- 2.4.1 Item 4.3-Face Brick
- a. BC-2 is incorrectly shown as Cameo Blend and shall be changed to 530 Kansas Brick & Tile, modular size, velour texture.
- 2.5 Section 06200 – Millwork
- 2.5.1 Note 10.2/G: Countertop supports shall be per Detail 6/A7.1.
- 2.5.2 Note 11/G: BLUM metafile drawer system in lieu of Variant 386.
- 2.6 Section 07610- Pre-finished Metal Components
Item 2B (Metal Wall Panel style) shall be deleted. The metal panels shown on the drawings are specified under section 09775.

- 2.7 Section 09300 – Porcelain Tile & FRP
Add item 7.6/H: **Cement Mortar for Shower Pans:**
Install the tile according to TCA method F112-98. For the mortar bed use LATICRETE 226 Thick Bed Mortar Mix gauged with LATICRETE 3701 Mortar Admix. Bowl out around the drain so the drain clamp is accessible. Use LATICRETE Latex Thin-set Mortar Additive and LATICRETE 211 Crete Filler Powder for the slurry bond coat to subfloor and for bonding the tile to the mortar bed. Use LATICRETE 9235 Waterproof membrane over the mortar bed after mortar beds initial set. Apply the 9235 liquid over the mortar bed and immediately, while still wet, apply the 9235 fabric, and immediately apply another coat of the 9235 liquid. After it is dry to the touch apply one more coat of the LATICRETE 9235 Waterproof membrane liquid over the whole area. Additional 6" fabric reinforcement should pre-treat all transitional areas. At drain make sure 9235 membrane overlaps flange. After it is dried to the touch apply a sealant around the drain flange and clamp. Fill in bowl with LATICRETE 226/3701 Mortar Mix. After mortars initial set continue the 9235 membrane over the surface of the mortar bed to the drain. Use a sealant around perimeter of drain. If a flood test is required allow 5 to 7 days of curing @ 70 F and 50% Humidity before testing. Follow manufacturers written instructions.).
- 2.8 Section 09650 – Resilient Floor Covering
Item 4.2/A: Shall include the following: Inside and outside base corners shall be field formed.
- 2.9 Section 10000- Classroom Equipment
2.9.1 Homosote Panels- Will not be required in classrooms and corridor E100 as specified.
2.9.2 Wall Carpet- Will not be required in new classrooms as specified.
- 2.10 Section 10800- Toilet Accessories
Stainless steel mirrors- The size of the mirrors shall be 24" x 36" as shown on A6.1 and not 18" x 24" as specified in this section.
- 2.11 Section 11500- Sports Equipment
2.11.1 Volleyball system- The general contractor shall provide and install six floor sleeves and cover plates in lieu of the four specified.
2.11.2 Wall Pads- Item 6 (c) shall be deleted.

III. CHANGES TO THE DRAWINGS:

- 3.1 Sheet CODE 2
Project Certification – Incorrectly states that the project shall comply with the 2000 International Fire Code. This shall be changed to the 2003 International Fire Code.
- 3.2 Sheet C1.0
3.2.1 Outside Basketball Goals.
a. There are (3) basketball goals shown on the existing site survey. To identify them, the single goal on the E-W drive will be Goal #1, continuing clockwise the next goal is on the N-S pavement line will be Goal #2 and last the goal furthest north will be Goal #3.
b. Goals #1 and 2 shall remain.
c. Goal #3 is in the path of the new construction. The General Contractor shall bid the removal and relocation (including repainting the pole) in the Base Bid. The exact location shall be determined by the Architect and Principal.

- 3.3 Sheet C1.1
- 3.3.1 The sidewalk shown on the north side of the new bus lane, then turning back to the north, stopping at the existing asphalt fire access lane (that extends to the northwest) is not shown on the site plan on sheet SP2. This “L” shaped sidewalk configuration shall be deleted from C1.1.
- 3.4 Sheet L1
- 3.4.1 The landscape screening shown with the Teacher Parking Lot shall be provided and installed by the Owner. The work will only be done with acceptance of Alternate 7.
- 3.4.2 The landscape screening shown with the Trash Enclosure shall be provide and installed by the Owner. The work will only be done with acceptance of Alternate 1.
- 3.5 Sheet SP-2
- 3.5.1 The paving and curb and gutter shall be modified to turn back into the existing fire lane as shown on sheet C1.0. A new accessible ramp shall be added in the far West point where the corrected curb and gutter would intersect the new gym. The ramp shall be ADA compliant with warning orbit strip at the bottom, 6’ wide, with a single flair on the south side.
- 3.6 Sheet SP-4
- 3.6.1 Parking Lot Plan “A”
- a. This parking lot, which shall be defined as the area between the back of curb - south curb on the new bus drive on the north and the drainage pipe and cast Deter curb on the south.
 - b. The steel bollards located just south of the south bus drive curb shall be included in the Base Bid. The bollards shown parallel with Dougherty Street shall be included in Alternate 7 – Teachers Parking lot.
 - c. The drainage pipe, new Deter curb, associated grading, sidewalk work at the pipe crossing and concrete curb work for the Deter curb shall be included in the Base Bid.
 - d. The concrete curb approach for the teacher’s parking lot and sidewalk work at this drive shall be included in Alternate 7. The concrete curb approach and sidewalk associated with the new bus drive shall remain in the Base Bid.
 - e. The work associated with the Teacher Parking Lot shall include but not be limited to – the perimeter concrete curb and gutter, asphalt paving, parking striping, (2) universal parking signs, E-W sidewalk located between the south bus drive curb and parking lots north curb, new concrete curb approach (compliant with the requirements of the City of Wichita, and the section of sidewalk just west of the new Teacher Parking Lot approach, and the site work (grading, cut and fill).
 - f. Site lighting as shown on Sheet E3.4.
The two light poles and concrete bases shown at the Teacher Parking Lot shall be included in the cost of Alternate 7. In the Base Bid an empty conduit (with pull rope) shall be extended to a point 3’ south of the new Bus Drive, located at the transition between the asphalt and concrete paving. The conduit shall be capped and marked with a #4 rebar drive into the ground.

3.7 Sheet A1.1

3.7.1 Corridor A102-

- a. Work in Corridor 102 – there will be some work on this space in both Phase 1 and Phase 2. The existing locker rooms can not be modified in Phase 1. Work in corridor 102 in Phase 1, must provide a save exit path during the times the existing gym is occupied by more then 50-people. This will require coordination between the building principal and General Contractor.
- b. The elevation indicator looking at the south wall of Corridor 102 should read “1/A6.5” in lieu of “1/A6.7”.

3.7.2 Room 105- The hollow metal window looking from Room 105 (Gym Office) to E138 (Girls Locker Room) shall be a type 4F frame.

3.8 Sheets A1.1, A1.2 and A1.3

The Legend incorrectly states that accessible compliant signage is by a separate contract. All classroom signage shall be included in the general contractor’s base bid.

3.9 Sheet A1.2

The existing exterior window between E124 and E125 is shown incorrectly. The existing window is divided in 3 equal lites similar to the adjacent windows. This project shall replace the center lites of glass with spandrel glass (glass type 7). The other windows existing vision glass shall remain. The wall between the two offices will meet this window in a fashion as illustrated below.

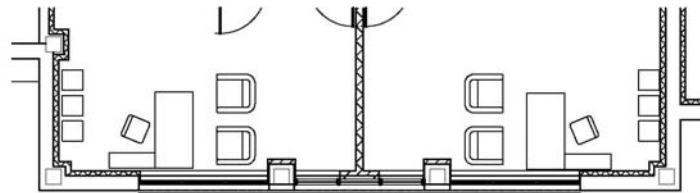

3.10 Sheet A1.4

3.10.1 Detail B: Clarification as to where the VCT at E135 stops. Patch and repair at areas of demo. Finish to align flush with existing. Material and color identified on Detail. Delete rubber transition and metal transition between corridor 102 and E135, and alcove to girl’s locker room in corridor E135.

3.10.2 Detail B: Quarry tile shall fill entire room. Box at northwest corner shall be deleted from plans.

3.11 Sheet A1.5

3.11.1. Detail “A” shall be corrected to show Alternate #2 in lieu of Alternate #4 as noted in the drawing title.

3.11.2 Detail “A”- The note stating “Refer to finish note #2 this sheet for additional information” shall be clarified to refer to finish notes on sheet A1.4.

3.11.3 Detail “A” – Small grid at exterior doors indicates quarry tile. Add floor transition Detail 12/A3.3 between commons 103 and existing corridor E136.

- 3.12 Sheet A2.0
- 3.12.1 There is an existing roof access ladder on the south side of the existing gym (connecting existing roofs 5 and 8). This roof access ladder is noted to be removed and reused. This ladder shall be modified as required, primed and painted, then installed to provide access from new roof 7 to new roof 2. The architect will field locate the final location, but it shall generally be located on the north side of the new lunchroom parapet wall.
- 3.13 Sheet A3.1
- 3.13.1 Room finish schedule for Vestibule 106 was mislabeled. Correct label shall be Hall 106.
- 3.13.2 Room finish schedule revision for Commons 103: Refer to elevation on Sheet A6.4 for all walls. South lower wall: W26/Upper wall paint. A6.4 shows west wall and extent.
- 3.13.3 Roof finish schedule Room E117: Paint all walls, color W2 on north, south and east walls. W3 on west wall. Delete reference to patten W27. All walls scheduled to be tuff board drywall.
- 3.13.4 Room finish schedule Gym 100: Entire floor is scheduled to be F9 wood flooring. Delete the reference to material F8, sealed concrete. Room shall have material B8 vented cove base. Delete the reference to B1 rubber base.
- 3.13.5 Room finish schedule, add room: Existing Corridor G5.
- a) Floor: F19 as required.
- b) Base: B7 as required.
- c) Walls: Pattern W23, elevations will be generated in the next addendum.
- d) Ceiling: Existing to remain.
- 3.13.6 Elevations showing E135, E136 and E137 shall accompany Addendum # 2.
- 3.14 Sheet A3.2
- 3.14.1 Clarification to material F10: Liners are located in pattern F24. F24 is specified for Vestibule E144. Sheet A1.4 detail E reflects extent.
- 3.14.2 Quarry tile in Pattern F24 is scheduled to receive full coverage of crack isolation membrane. Pattern F25 and F26 are scheduled to include schluter-ditra-xl in floor prep full room coverage.
- 3.14.3 Clarification on location of material W10: refer to pattern W20.
- 3.15 Sheet A3.4
- 3.15.1- Door Schedule- Door 104a should be a W2 door in lieu of a W1.
- 3.15.2- Door Schedule- Doors E103b, E104a and G3a shall have 1F frames in lieu of the 3F frames shown.
- 3.16 Sheet A6.2 – Detail 4
TS cabinet shall be lockable.
- A3.17 Sheet A6.3
General contractor shall refer to 22/A3.3 for additional information on corner guards shown.

- 3.18 Sheet A7.1
3.18.1 All details on this page shall be corrected to reflect 3 1/2" HT x 2 1/2"D toe kick.
- 3.18.2 Detail 6: Nosing should reference 1/A7.5 in lieu of 3/A7.5.
- 3.19 Sheet A7.3
3.19.1 Detail 5: Height should be 7'-0" in lieu of 4'-0"
- 3.20 Sheet A7.5
3.20.1 Detail 11: (7)-ply Baltic Birch shall be 5/8" in lieu of 1/2".
- 3.20.2 Detail 17: Doors and drawers shall have a 3mm radius in lieu of 1/2" radius corners.

IV. CHANGES TO THE STRUCTURAL DRAWINGS:

- 4.1 Sheet S2.1
Detail "C" Partial Foundation Plan- Occurs in Counselor E124. It is the infill for an existing grease trap opening.
- 4.2 Sheet S2.2
Detail "D" Partial Existing Roof- Occurs above Toilet Room E114 and E118.

V. CHANGES TO THE ELECTRICAL DRAWINGS:

5. Sheet E3.4
- 5.1 The (2) "S1" parking lot lights and concrete bases shown south of the new Teacher Parking Lot shall be included in Alternate 7. In the Base Bid an empty conduit (with pull rope) shall be extended to a point 3' south of the new Bus Drive, located at the transition between the asphalt and concrete paving. The conduit shall be capped and marked with a #4 rebar drive into the ground.
- 5.2 The (2) "S2" parking lot lights, concrete bases, curitry, wiring, conduit, ect. shown for the Alternate 6 – on street parking shall be deleted from this project.

END OF ADDENDUM ONE