

TYPICAL CUT JOINT PLAN
N.T.S.

1. IN CASE OF EXISTING BRICK MANHOLES, BRICKS SHALL BE REMOVED OR ADDED AS NECESSARY FOR GRADE ADJUSTMENT. BRICKS SHALL BE PLACED IN MORTAR BED (TYP.).
2. FOR SANITARY APPLICATIONS 1/2" MORTAR FINISH SHALL BE APPLIED TO EXTERIOR BRICK SURFACE OF MANHOLE.
3. ALL EXCAVATION, BACKFILL, MATERIALS AND INCIDENTAL WORK REQUIRED FOR COMPLETE INSTALLATION SHALL BE SUBSIDIARY TO ADJUSTMENT BID ITEMS.
4. ALL PRECAST RISERS, CONES, ADJUSTMENT OR GRADE RINGS, ETC., NECESSARY FOR ADJUSTMENT, SHALL BE MANUFACTURED ACCORDING TO THE MOST RECENT ASTM SPECIFICATIONS AND SPECIAL PROVISIONS. CONE SECTIONS SHALL BE ECCENTRIC TYPE WHEN REQUIRED.
5. ALL MANHOLE CONSTRUCTION SHALL BE WATER TIGHT. ALL JOINTS SHALL BE FILLED WITH MORTAR OR PLASTIC JOINT COMPOUND AS SPECIFIED IN THE STANDARD SPECIFICATIONS. NO PAYMENT WILL BE MADE FOR THIS WORK.
6. ADJUSTMENT OR GRADE RINGS SHALL BE FORMED WITH TONGUE AND GROOVE OR LUGS AND NOTCHES. RINGS SHALL BE SET IN MORTAR.

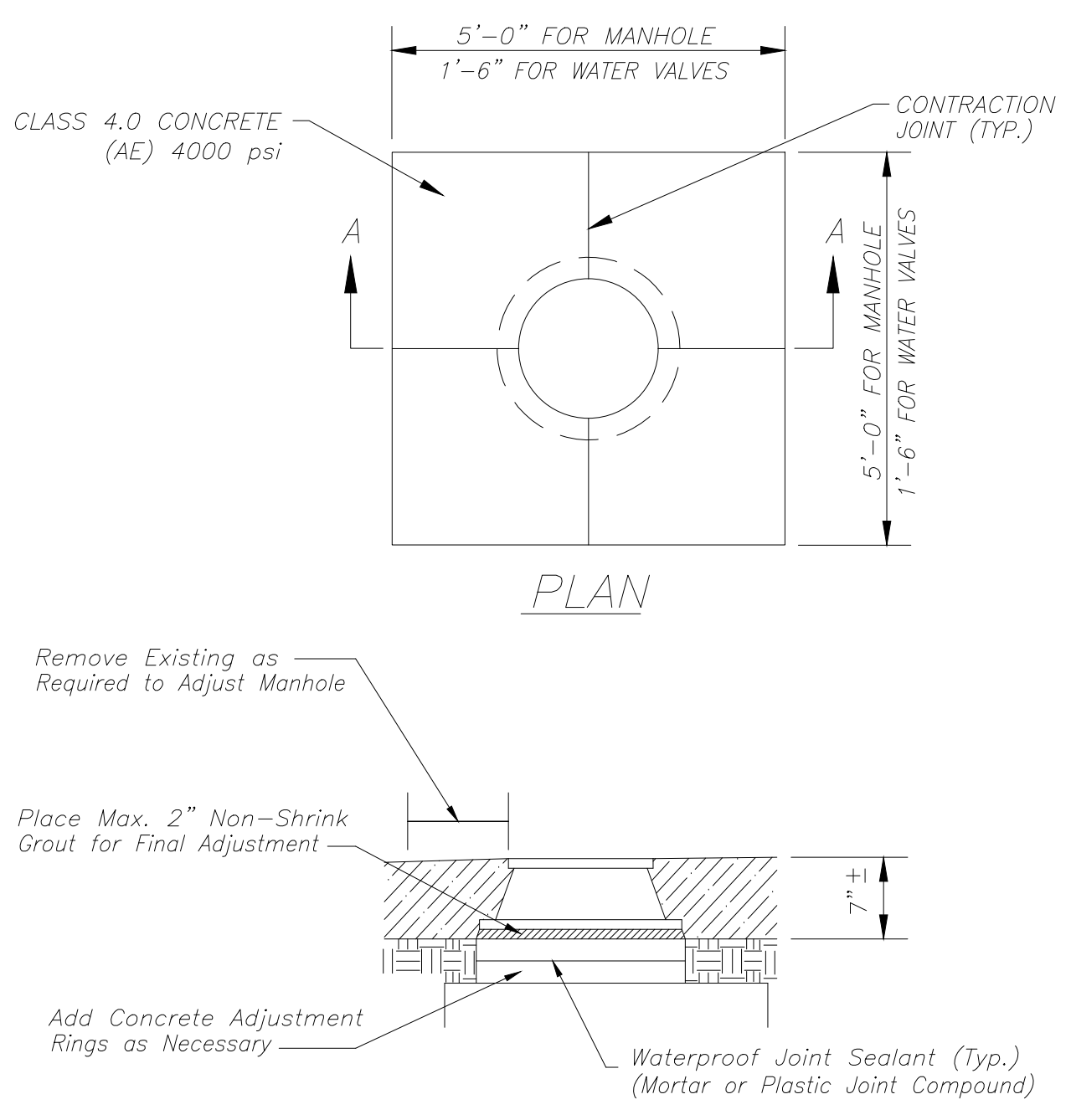

WATER VALVE BOX AND MANHOLE ADJUSTMENT DETAIL
N.T.S.

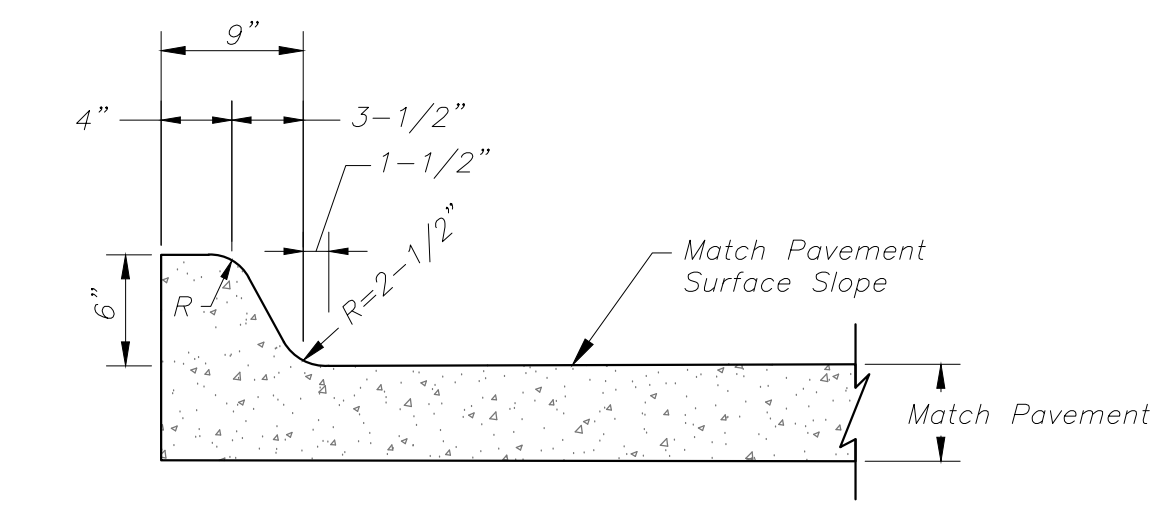

EDGE CURB SECTION

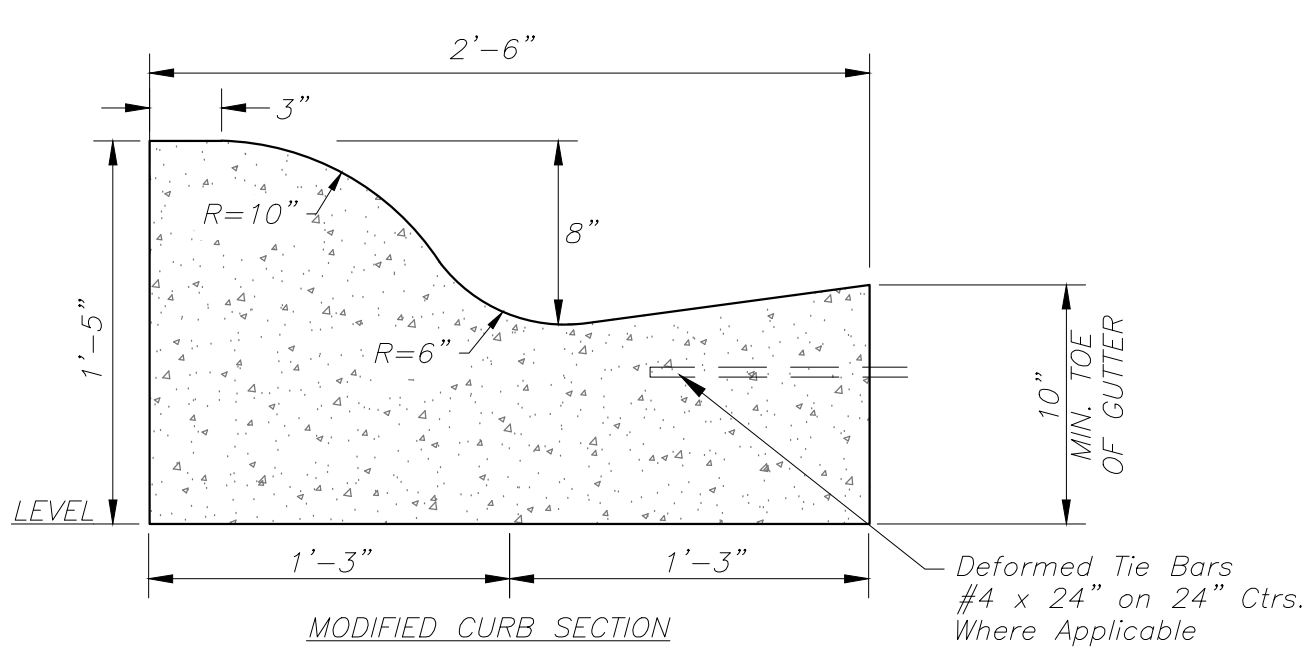

MODIFIED CURB SECTION

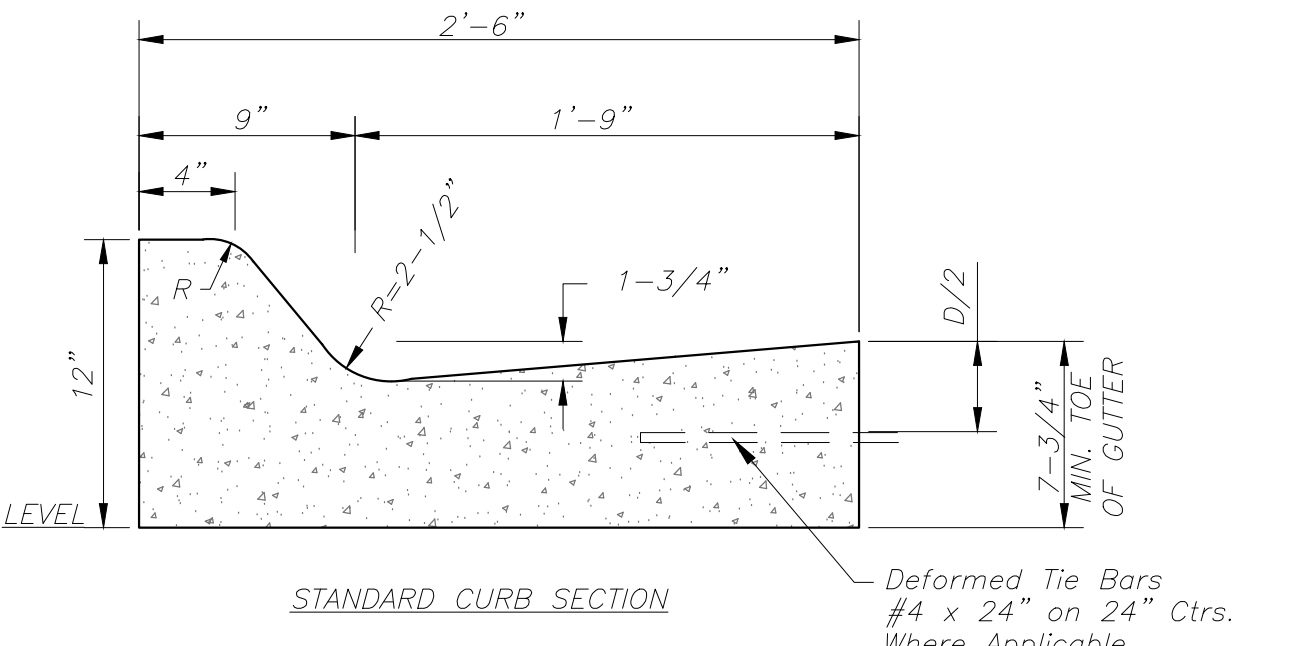

STANDARD CURB SECTION

CONTRACTOR MAY SUBMIT ALTERNATE CURB & GUTTER CONFIGURATION FOR CONSIDERATION PRIOR TO LETTING

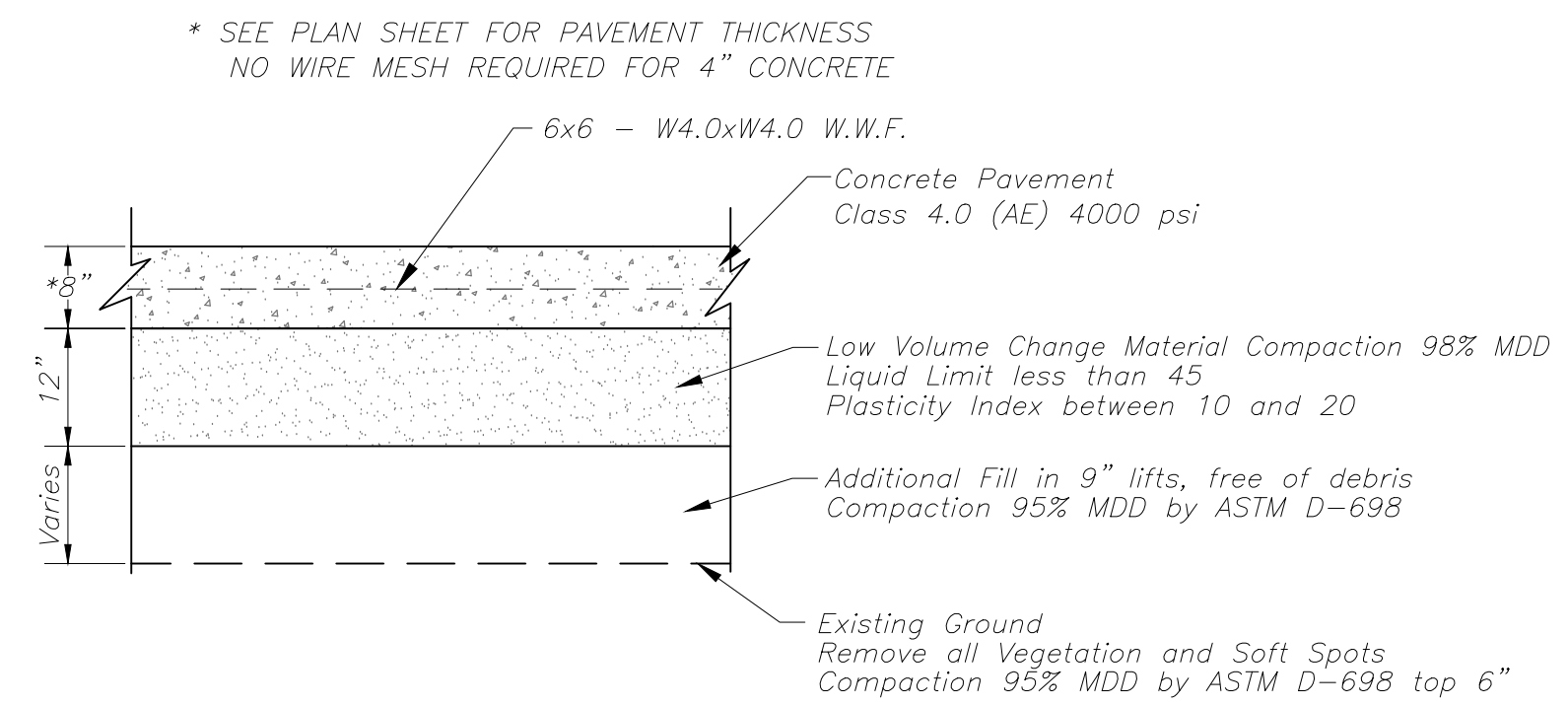

CONCRETE PAVING SECTION
N.T.S.

SEE GEOTECHNICAL ENGINEERING REPORT FOR MORE INFORMATION

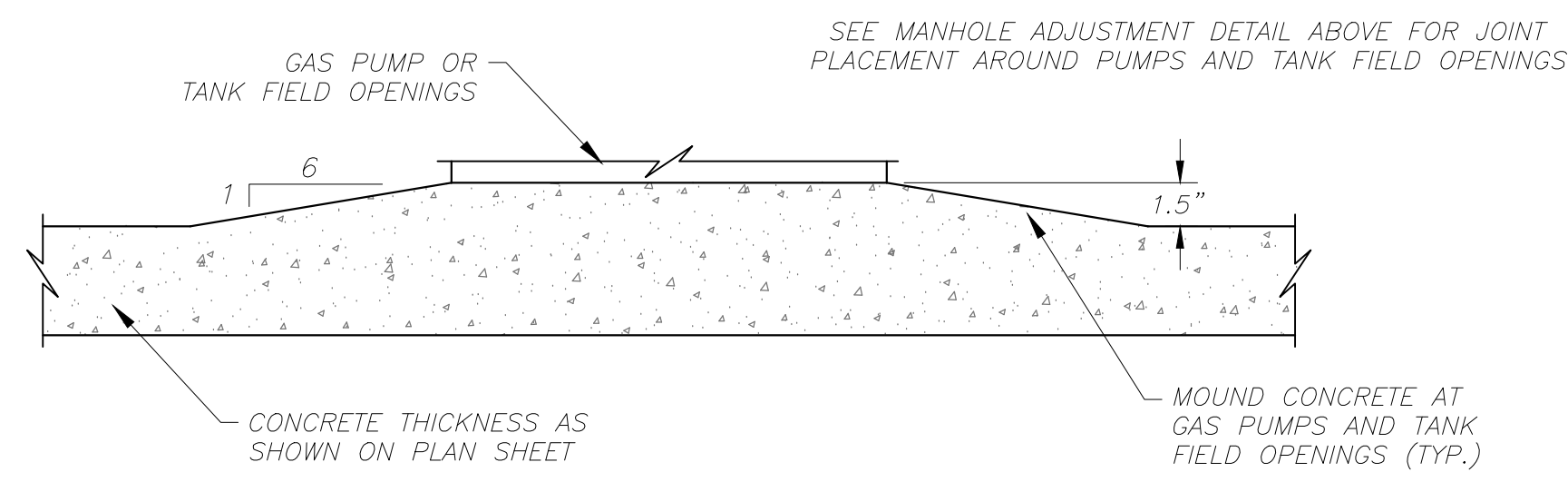

GAS PUMP & TANK FIELD OPENINGS DETAIL
N.T.S.

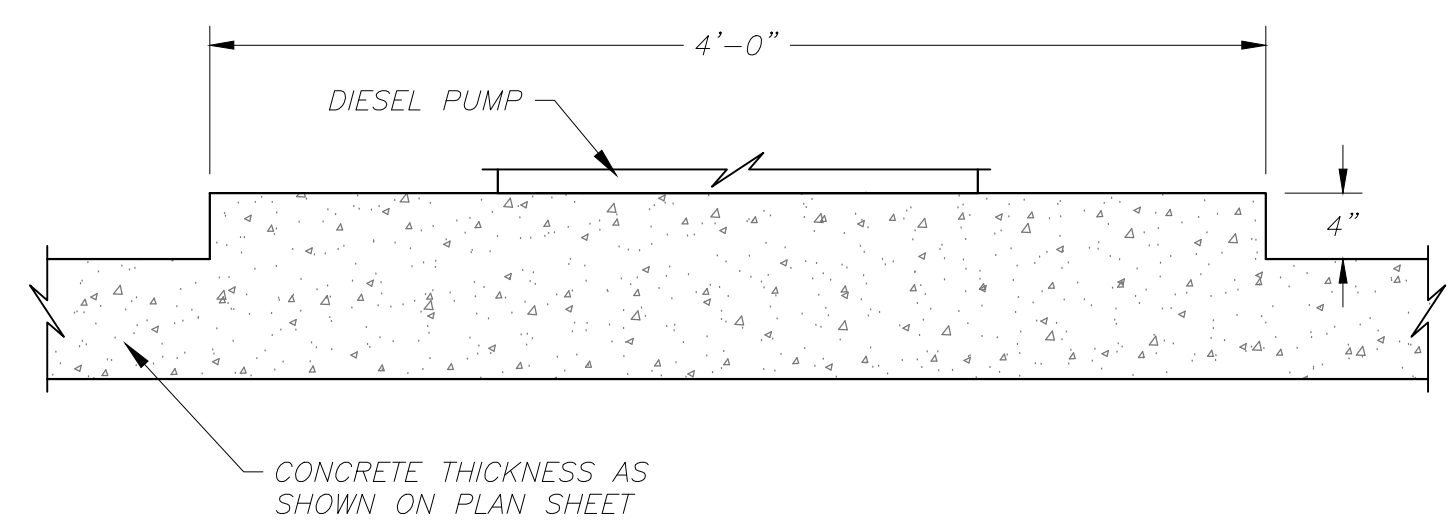

DIESEL PUMP DETAIL
N.T.S.

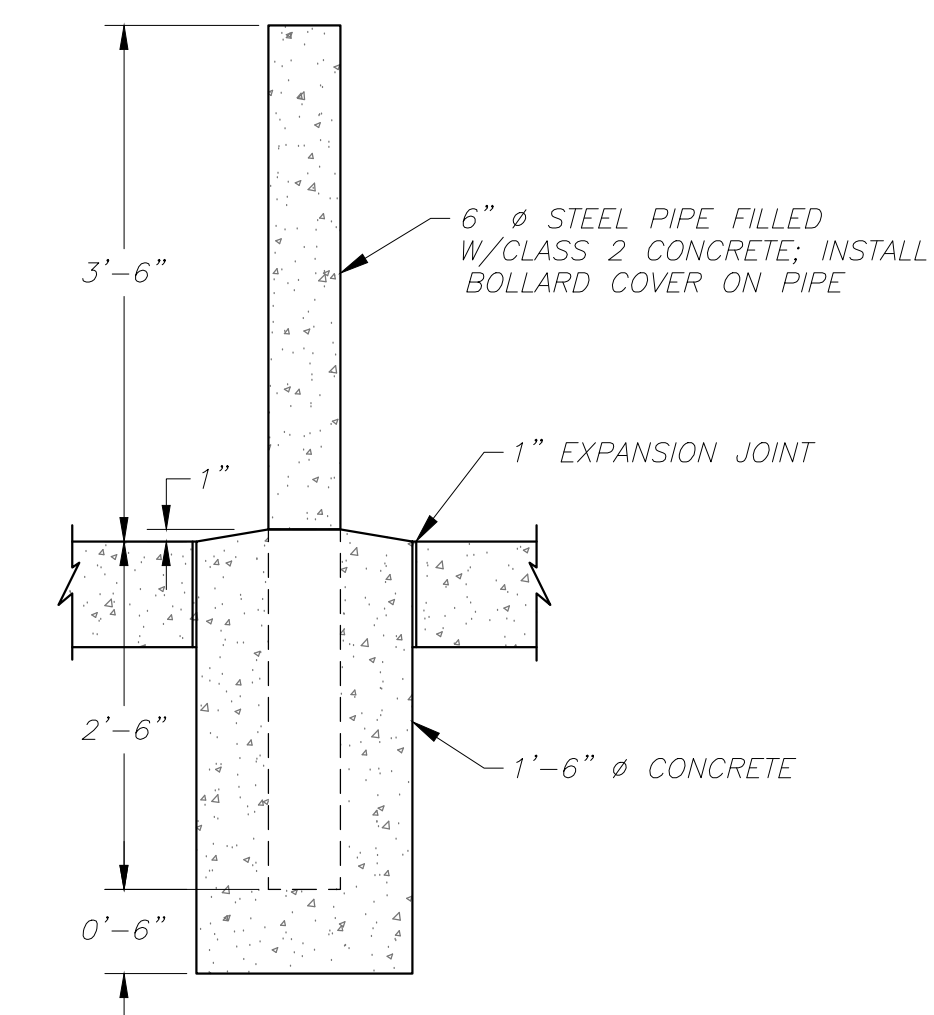

STEEL BOLLARD DETAIL
N.T.S.

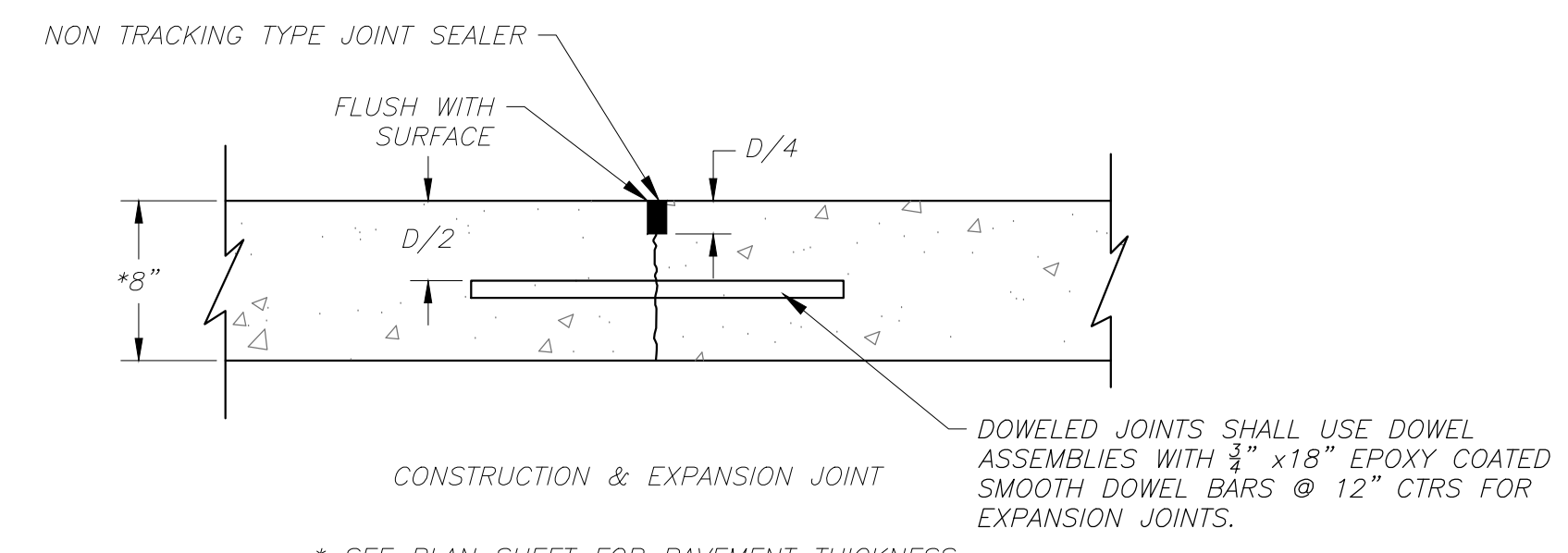

CONSTRUCTION NOTES:

1. PLANES OF WEAKNESS SHALL BE CONSTRUCTED UNIFORMLY THROUGH CONCRETE PAVEMENT & CURB AND GUTTER SECTIONS AT 10' MAXIMUM INTERVALS, AND SIDEWALK AT 5' MAXIMUM INTERVALS.
2. FINAL SURFACE FINISH - A BURLAP DRAG OR A BROOM FINISH SHALL BE USED AS THE FINAL FINISHING METHOD (NO STEEL TROWELLING).
3. CURING - CONCRETE SHALL BE CURED BY SPRAY LIQUID MEMBRANE, HUNT'S PROCESS OR EQUAL. (ASTM C-309).
4. EXPANSION JOINTS OF 1" PREMOLDED EXPANSION JOINT FILLER (NONEXTRUDING, TYPE B) CUT TO THE DIMENSIONS OF THE CURB AND GUTTER SHALL BE PLACED AT THE END OF CURB RETURNS. EXPANSION JOINTS SHALL BE SEALED WITH 1" OF HOT OR COLD POURED JOINT SEALING COMPOUND.
5. EXPANSION JOINTS AT APPROACH SLABS SHALL BE 5" OF PREMOLDED EXPANSION JOINT FILLER (NONEXTRUDING, TYPE B) AND 1" OF HOT OR COLD POURED JOINT SEALING COMPOUND.
6. PLACEMENT & STRIKE OFF - PLACEMENT WILL BE BY AN APPROVED VIBRATORY SCREED SUFFICIENT TO PLACE AND PENETRATE 2-1/2" SLUMP CONCRETE FOLLOWED WITH BULLFLOAT. AN EDGER OF 1/4" RADIUS WILL BE USED AT FORM LINES.

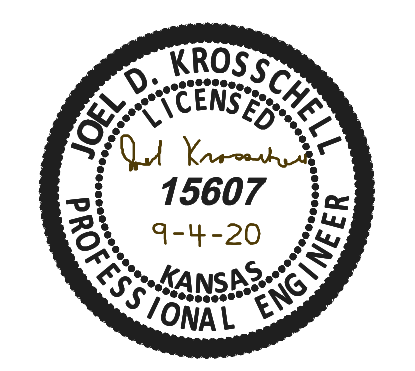
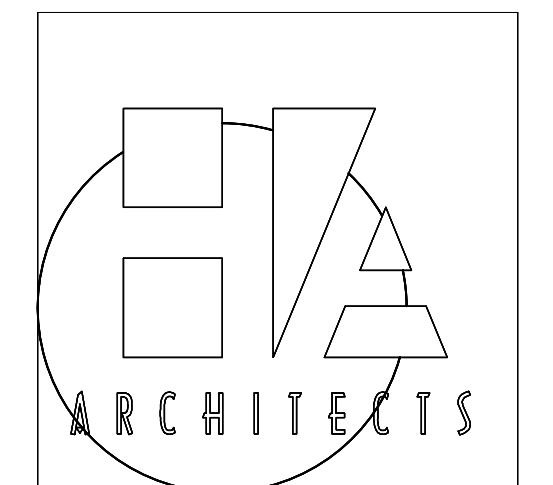

HANNEY & ASSOCIATES, ARCHITECTS
1726 South Hillside, Wichita, Kansas, 67211
Phone (316) 683-8965
Fax (316) 684-1441
www.haarchitects.com

24/7 TRAVEL STORE
 2020
 24-7 TRAVEL STORE
 2710 Commerce Rd.
 Goodland, Kansas

DRAWINGS ISSUED		
NO.	DATE	ITEM ISSUED
1	9-4-20	ADDENDUM #1

COMPUTER DRAWING

DATE: AUGUST 2020
DRAWN BY: CHECKED BY:

SHEET
C1.5
SITE DETAILS
OF SHEETS