

B FLOOR PLAN
 SCALE: 1/8" = 1'-0"
 NORTH

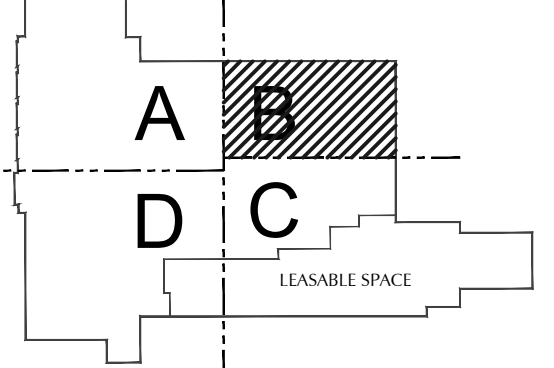

- PLUMBING PLAN NOTES:**
 REMOVE ALL EXISTING PLUMBING. CAP BELOW FLOOR
 FIELD VERIFY EXACT LOCATION.
- ◆ TIE INTO EXISTING SANITARY SEWER
 FIELD VERIFY EXACT LOCATION.
 - ◆ SPRINKLER CONTRACTOR TO MOVE EXISTING
 SPRINKLER MAIN, RISER, AND WATER METER
 FIELD VERIFY EXACT LOCATION.
 - ◆ WATER UNDERGROUND TO BAR
 P.C. TO NOTIFY GAS UTILITY OF GAS LOAD AND PAY ALL FEES.
 - ◆ SEE STEAM DETAIL SHEET
- PLAN REVIEW NOTES:**
- ① GREASE TRAP PER PLAN REVIEW NOTE 32
 - ② FIXTURE AMENDED PER PLAN REVIEW NOTE 19
- ADDEMUDA 4**
- ③ CHANGE TRENCH DRAIN



HANNEY & ASSOCIATES ARCHITECTS
 1726 South Hillside, Wichita, Kansas, 67211
 Phone (316) 683-6865
 Fax (316) 684-1441

2021 GENESIS HEALTH CLUBS
SOUTHRIDGE MALL
 1111 East Army Post Road
 Des Moines, Iowa 50315



DRAWINGS ISSUED			
NO.	DATE	ITEM	ISSUED
12	5/4/22	ADDENDA #4	
11	4/24/22	ADDENDA #3	
10	3/25/22	CODE REVISIONS	
9	2/11/22	PERMIT SET	
8	1/25/22	CHECK SET	
7	12/15/21	CHECK SET	
6	9/24/21	CHECK SET	
5	8/21/21	SITE PLAN REVIEW	
4	7/21/21	UDRB SUBMITTAL	
03	7/08/21	MILESTONE DEV. PLAN	
02	5/25/21	CONCEPT. DEV. PLAN	
01	3/20/21	CONCEPT. DEV. PLAN	

COMPUTER DRAWING

DATE: AUGUST 2021
DRAWN BY: RJB **CHECKED BY:** NEM

SHEET

P1.3

OF - **SHEETS**

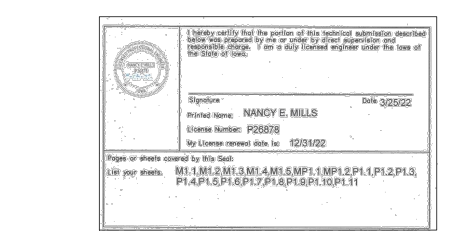

MECHANICAL CONCEPTS L.L.C.
 14801 TIMBERLAKE RD.
 WICHITA, KANSAS 67230
 PHONE: 316-733-2718
 FAX: 877-839-4680
 EMAIL: RB@RICHARDBOWMAN.US

PLUMBING WASTE&VENT