



7/16/19

HANNEY & ASSOCIATES, ARCHITECTS
 1726 South Hillside, Wichita, Kansas, 67211
 Phone (316) 683-8965
 Fax (316) 684-1441
 www.haarchitects.com

NOTE: INTERIOR FLOOR FINISH SHALL BE HARDENED AND SEALED CONCRETE WITH SLIP RESISTANT GRIT AND 4" RUBBER COVE BASE, TYP.

USE DENSIFIER - LITHIUM BASED CHEMICAL DENSIFIER SPECIFICALLY FOR CONCRETE SURFACE TREATMENT WHICH REACTS CHEMICALLY TO THE CONCRETE SURFACE FORMING A CLEAR, DENSE, DURABLE, HARD, ABRASION RESISTANT SURFACE. PRODUCT SHALL BE COLORLESS, ODORLESS, WATER BASED SOLUTION THAT IS LESS THAN 50 VOC. *AMERIPOLISH 3D H* OR APPROVED EQUAL.

CONCRETE SEALER: NO TOPICAL COATINGS. PENETRATING LIQUID SEALER THAT IS CHEMICALLY REACTIVE, WATER BORNE SOLUTION, COLORLESS, ODORLESS WHICH HARDENS SURFACES TO PROTECT AGAINST ABRASION AND ABSORPTION OF LIQUIDS. *AMERIPOLISH SR2* OR APPROVED EQUAL.

MICRO ROUGHNESS OF SURFACE: A SAFE SURFACE TO PROVIDE HIGHER LEVEL OF SLIP RESISTANCE WHEN WET. ACHIEVE WITH A SURFACE ROUGHNESS FINE ENOUGH NOT TO DETRACT FROM THE APPEARANCE.

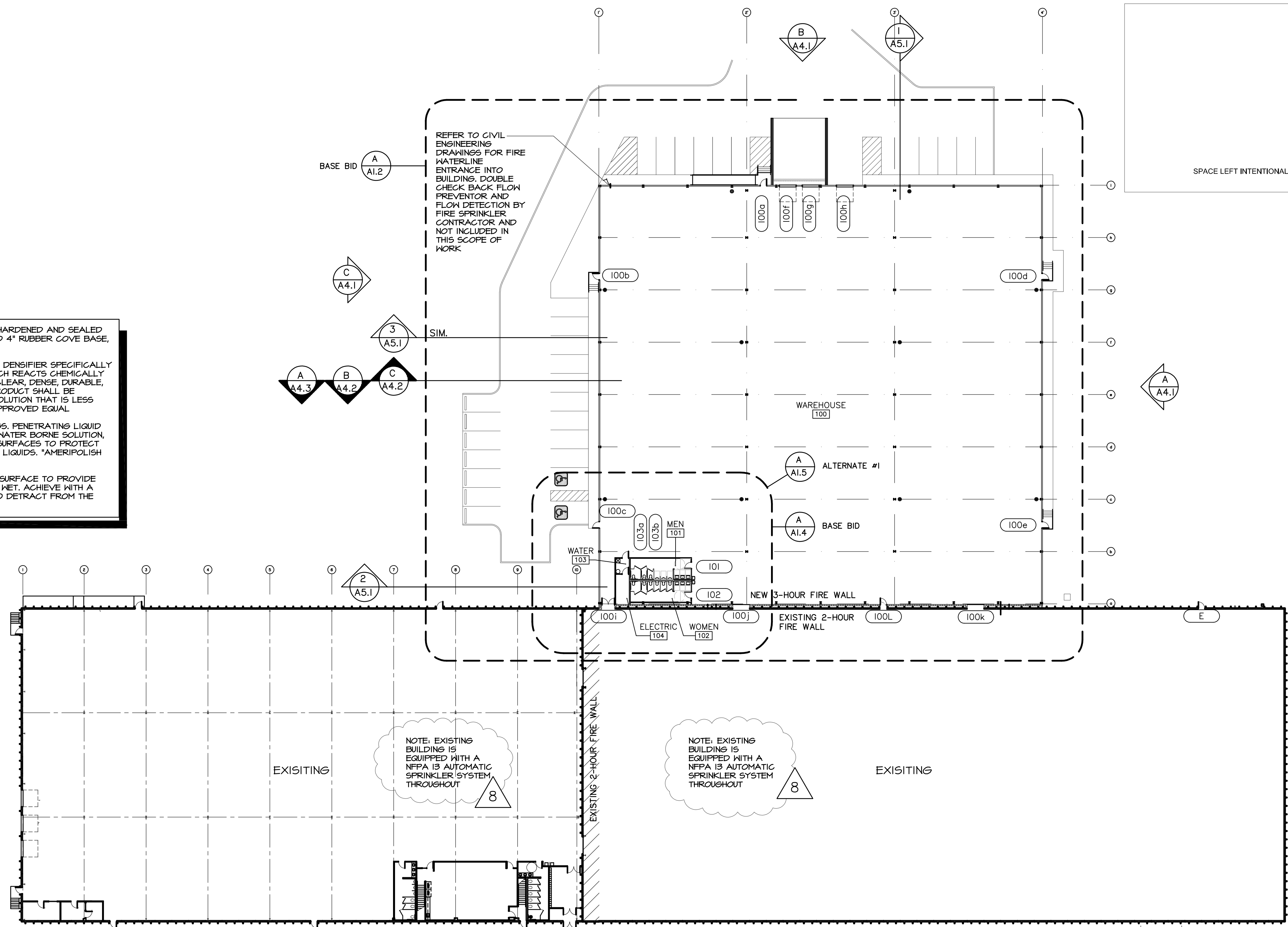

REFER TO CIVIL ENGINEERING DRAWINGS FOR FIRE WATERLINE ENTRANCE INTO BUILDING. DOUBLE CHECK BACK FLOW PREVENTOR AND FLOW DETECTION BY FIRE SPRINKLER CONTRACTOR AND NOT INCLUDED IN THIS SCOPE OF WORK.

SPACE LEFT INTENTIONALLY BLANK

A OVERALL FLOOR PLAN
 SCALE: 1" = 30'-0"
 NORTH PLAN NORTH

2019 BOOT BARN WAREHOUSE EXPANSION
 4950 South Laura, Wichita, Kansas 67216

SCHEDULE OF WALL TYPES

SCALE: 1 1/2" = 1'-0"

<p>UL DESIGN NO.: U419 NONBEARING FIRE RATING: 1-HOUR ASSEMBLY</p> <p>A1 WALL TYPE</p>	<p>UL DESIGN NO.: U419 NONBEARING FIRE RATING: 1-HOUR ASSEMBLY</p> <p>A2 WALL TYPE</p>	<p>UL DESIGN NO.: U419 NONBEARING FIRE RATING: 1-HOUR ASSEMBLY</p> <p>A3 WALL TYPE</p>	<p>UL DESIGN NO.: U419 NONBEARING FIRE RATING: 1-HOUR ASSEMBLY</p> <p>A4 WALL TYPE</p>	<p>UL DESIGN NO.: U419 NONBEARING FIRE RATING: 1-HOUR ASSEMBLY</p> <p>A5 WALL TYPE</p>	<p>UL DESIGN NO.: U419 NONBEARING FIRE RATING: 1-HOUR ASSEMBLY</p> <p>A6 WALL TYPE</p>	<p>A7 NOT USED</p>
<p>M1 WALL TYPE</p>	<p>M2 WALL TYPE</p>	<p>REFER TO STRUCTURAL DRAWINGS FOR ADDITIONAL REINFORCING INFORMATION</p> <p>B1 WALL TYPE</p>	<p>WALLTYPE GENERAL NOTES</p> <p>REMARKS</p> <ol style="list-style-type: none"> 1. TABLE REQUIRES FULL HEIGHT SHEATHING ON BOTTOM OF DECK. 2. THE TOILET ROOM WALLS AND DEMISING WALL BETWEEN THEM SHALL EXTEND TO THE DECK. 3. STUDS SHALL BE INSTALLED PER MANUFACTURER DETAILS AND REQUIREMENTS. 4. CONFLICTS BETWEEN THIS INFORMATION AND INFORMATION SHOWN ON THE STRUCTURAL SHEETS - THE STRUCTURAL SHEETS SHALL GOVERN. 5. IF THE G.C. WISHES TO DEVIATE FROM THE SUGGESTED STUD SIZES SHOWN, THE G.C. SHALL OBTAIN THE WRITTEN APPROVAL FROM THE STRUCTURAL ENGINEER. 6. APPLY VAPOR/MOISTURE PROOF SYSTEM ON EXPOSED SIDE OF SHOWER AND STEAM WALLS AND CEILING. APPLY FINISH MATERIAL ON TOP OF VAPOR/MOISTURE PROOFING SYSTEM. 7. USE MOISTURE-RESISTANT G.W.B. IN ALL WET AREAS (RESTROOMS, KITCHENS, DRINKING FOUNTAINS, ETC.) TO A HEIGHT OF 8'-0" MIN. TYPICAL. REFER TO FINISH DETAILS AT TILED WALLS. 8. EXPOSED VERTICAL CONCRETE SHALL BE SAND BLASTED TO A MEDIUM FINISH. 9. SHOWERS AND STEAM ROOMS SHALL ONLY BE SHEATHED WITH GEMENT BOARD. MOISTURE RESISTANT G.W.B. IS NOT ACCEPTABLE. 10. REFER TO CODE PLANS TO LOCATE WHERE FIRE RATED CONSTRUCTION APPLIES. 			

DRAWINGS ISSUED		
NO.	DATE	ITEM ISSUED
8	8/13	PLAN REVIEW REV. 2
7	7/15	PLAN REVIEW REV. 1
6	6/25	PLAN REVIEW
5	6/14	100% REVIEW
4	6/05	PLAN CHANGE
3	5/28	PLAN CHANGE
2	4/26	REVIEW
1	1/24	REVIEW

COMPUTER DRAWING
 BB_A101.dwg

DATE: JUNE, 2019
 DRAWN BY: MRH
 CHECKED BY: MRH

SHEET
A1.1
 OF 1 SHEETS